

# BATRIx

Freedom from the socket - FOR MORE THAN 100 MINUTES OF WORK!\*



### BATRIx L 36-18V

Wet/dry vacuum cleaner, dust retention capacity min. 99.9 % according to dust class „L“

100999



### BATRIx M 36-18V

Wet/dry vacuum cleaner, dust retention capacity min. 99.9 % according to dust class „M“

100777



Article no.	100999	100777
Scope of delivery	Hose EL 35-400 (electrically conductive), connection sleeve rotatable, 1 x handle ES, 2 x suction tube ES, 1 x floor nozzle 30, 1 x Cordless Control (CoCo)	Hose EL 35-400 (electrically conductive), connection sleeve rotatable, 1 x handle ES, 2 x suction tube ES, 1 x floor nozzle 30, 1 x Cordless Control (CoCo)
Accessories	<b>Optional:</b> battery pack 18V Li-HD 10.0 Ah, art. no. 457031, quick charger ASC 145 art. no. 448855	<b>Optional:</b> battery pack 18V Li-HD 10.0 Ah, art. no. 457031, quick charger ASC 145 art. no. 448855
Filter bag	1 pc. FBV 25/35 After sales art. no. 411231 (5 pack)	3 pcs. FBPE 25/35 After sales art. no. 425764 (5 pack)
Equipment		
Main filter	FKP 4300 (Polyester) Dust retention: 99,9 % Art. no. 416069	FKP 4300 (Polyester) Dust retention: 99,9 % Art. no. 416069
Impulse filter cleaning	yes, during work breaks	yes, during work breaks
starbox holder (Systainer system), not lockable	yes (lockable with „Unifix“, order separately art. 449432)	yes (lockable with „Unifix“, order separately art. 449432)
Speed controller	yes	yes
Filter control light	yes	yes
Carrying handle, hose fixing	yes	yes
Pre-selection switch volume flow/ hose ø	no	yes 15, 21, 27, 32, 35
Electrical volume flow monitoring with optical + acoustic warning function	no	yes
Rotary vane: flexible use of fleece filter bags and PE emptying bags	yes	yes
Closure for intake manifold	yes	yes
Soft start / after-run	yes	yes
Water level detection (Auto shut-off)	yes	yes
Electrostatic discharge	yes	yes
Accessories storage	yes	yes
Technical data		
Voltage	Volt 36V (1 x 36V / 2 x 18V)	36V (1 x 36V / 2 x 18V)
Running time at 2 x 18V 10.0 Ah (approx.) <b>(we recommend the use of 10.0 Ah batteries. For CAS batteries with less Ah: significantly shorter runtime!)</b>	Boost: 21 min Eco: 34 min Low: 100 min	Boost: 21 min Eco: 34 min Low: 100 min
Charging time 1 x battery 18V 10.0 Ah	75 min	75 min
Volume flow (max.) measured at motor head / hose end	l/s 67 / 38	67 / 38
Vacuum (max.) measured at motor head / hose end	mbar 240 / 213	240 / 213
Container volume (max.) gross-dust-water	25/20/15 plastic	25/20/15 plastic
Sound pressure level	dB(A) 69	69
Dimensions	L x W x H 45 x 40 x 57,5 cm	45 x 40 x 57,5 cm
Filter surface	cm² 8.600	8.600
Weight	kg 12,5	12,5
Price without VA	EURO 729,00	799,00



More information  
[www.starmix.de/en](http://www.starmix.de/en)



ELECTROSTAR GmbH • Hans-Zinser-Str. 1-3 • D-73061 Ebersbach  
☎ +49 7163 9988-100 • [www.starmix.de/en](http://www.starmix.de/en) • [info@starmix.de](mailto:info@starmix.de)

CRAFTS

VACUUM CLEANER **BATRIx**

**starmix**  
Made with Passion. Made for you.

**NEW**  
Cordless vacuum cleaner -  
but mains power performance



„STRONG - FLEXIBLE - CORDLESS.  
GET YOUR BATRIx NOW!“



BATRIx - the first cordless vacuum cleaner with GIANTPOWER - NEVER SEARCH SOCKETS AGAIN!

In front of you is unavoidable work. All around you there is no power outlet, no generator, no colleague who can help out. That means eating dust or being eaten. But not with you! You casually take your vacuum cleaner to the place where it is to be used and start off well protected.

**DAS WICHTIGSTE AUF EINEN BLICK**

	<p><b>Full Power</b></p> <p>The first cordless vacuum cleaner in the world with suction power comparable to that of a power supply unit.</p> <p>The 3-stage power regulation also allows longer battery life.</p>		<p><b>World innovation Cordless Control</b></p> <p>With the unique Cordless-Control, the ON/OFF/AUTO control of the vacuum cleaner can now also be controlled via a battery-powered electric tool.</p>
	<p><b>Extremely durable</b></p> <p>A newly developed brushless motor and the intelligent motor control ensure</p> <ul style="list-style-type: none"> <li>- longer life</li> <li>- higher efficiency</li> <li>- more power per battery charge</li> </ul>		<p><b>One battery for everything</b></p> <p>Compatible with the leading Battery technology in the industry - all 18V or 36V battery packs of the manufacturer-independent CAS-systems are usable.</p>
	<p><b>Extensive storage option on the vacuum:</b></p> <ul style="list-style-type: none"> <li>- accessories (depot on the back)</li> <li>- Suction hose (2 retractable hooks)</li> <li>- Systainer (Not lockable. Lockable only with separate Adapter plate „Unifix“ item no. 449432)</li> </ul>		<p><b>Clean Filter</b></p> <p>The electromagnetic pulse filter cleaning cleans the filters during the work break, so you can continue to vacuum with an unchanged high airflow.</p>
	<p><b>Stop dust:</b></p> <p>The vacuum cleaner is available in the version for dusts of class „L“ (not hazardous to health) and class „M“ (hazardous to health).</p>		<p><b>High quality accessories</b></p> <p>With electrically conductive suction hose, stainless steel pipes and handle, BG-Bau compliant floor nozzle and adapter for connection to power tool.</p>



# CORDLESS CONTROL

**Cordless Control - the clever partner for the vacuum cleaner - BEING LAZY WORK!**

You have your battery tool in your hand and you feel the workflow. Now you don't have to get off the ladder or climb over anything on the floor to switch your vacuum cleaner on and off. With CoCo you save yourself that!

Cordless Control (CoCo) is a world first. The innovative transmitter that can be connected to the suction hose or power tool. Using a vibration sensor, CoCo detects the operating status of the power tool (ON/OFF) and **automatically** switches the vacuum cleaner on or off by radio signal to the receiver (built into the Batrix). Optionally, the vacuum cleaner can also be started by **manually** actuating the transmitter (CoCo). It could not be more convenient.

- The system can be used with any battery AND power tool on the market
- Long battery life, up to 10,000 hours of use with power tool in operation
- The coupling of suction and device is very simple
- Manual and automatic mode

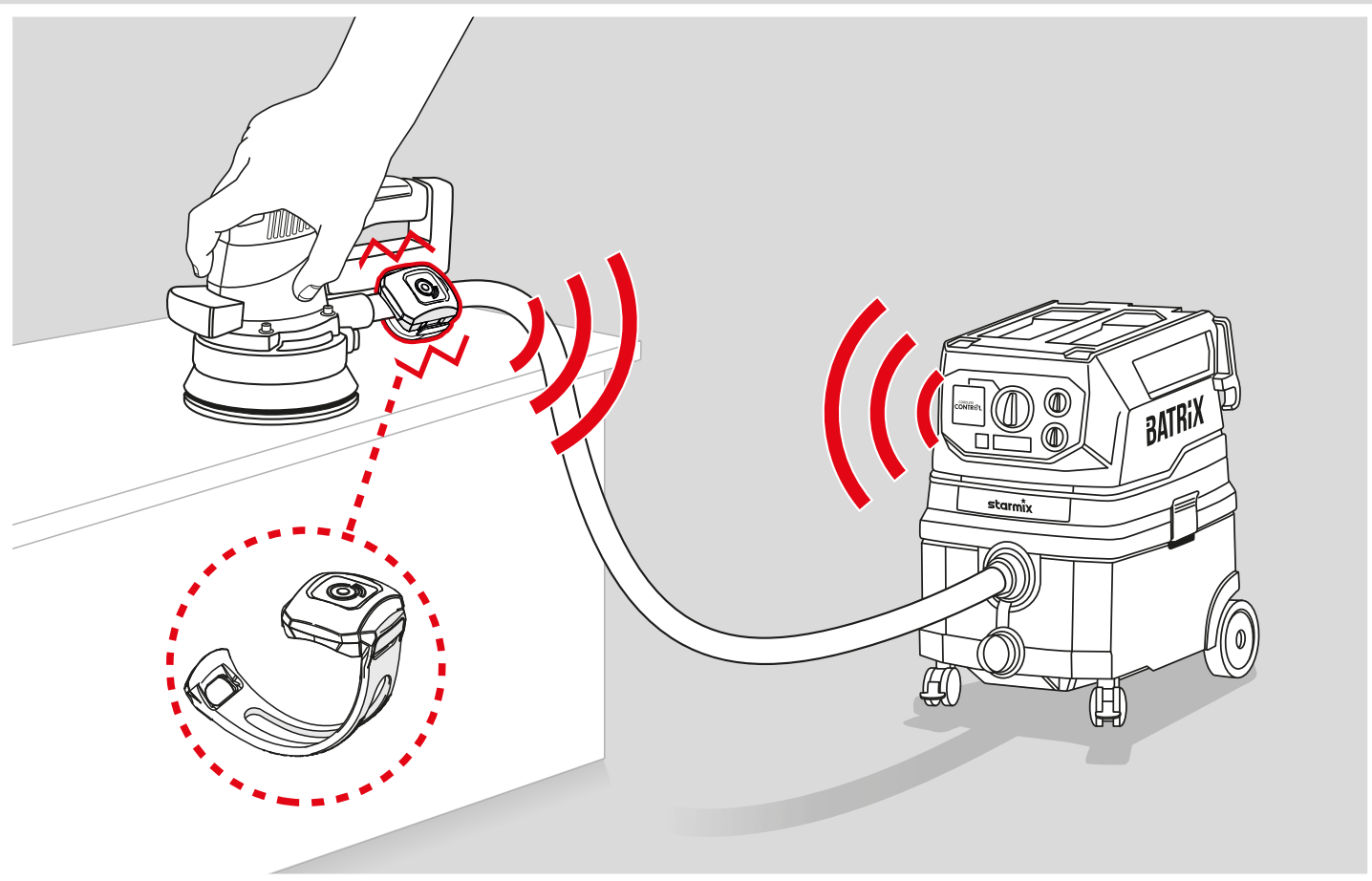

Innovative vibrationsensor (CoCo) on the suction hose, for coupling the battery power tool and the vacuum cleaner (receiver integrated in the Batrix)

## CORDLESS CONTROL

Battery compartment for 2 x 18V or 1 x 36V battery pack

**Main switch:**  
ON with 3-stage speed controller  
AUTO (automatic switch-on)  
- ON/OFF via Cordless Control  
- 3-stage speed controller  
OFF

**Filter cleaning:**  
AUTOMATIC  
MANUAL  
OFF (vibrator off)

Battery management with temperature monitoring and charge control display

Vacuum cleaner dust class M with preselector  
Hose Ø  
15, 21, 27, 32, 35 mm

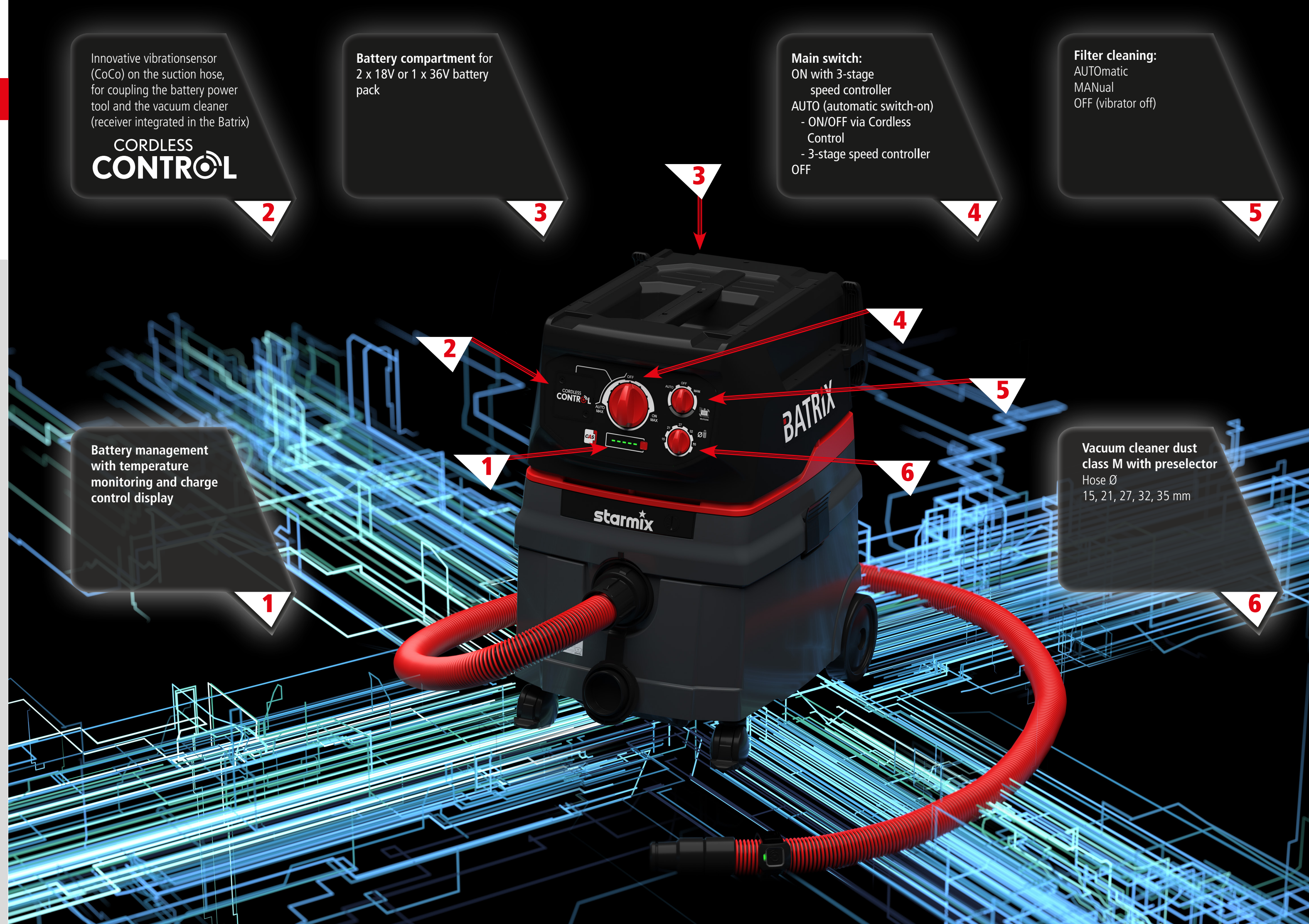

## One battery for everything.



CAS (Cordless Alliance System) is a multi-vendor battery system from leading power tool brands. They combine innovative spirit, high product performance and the common goal of making professionals independent of the power outlet.



**100% Compatibility for 180 machines in the 18-volt class!**

With CAS batteries, machines, battery packs and chargers from different manufacturers can be easily combined with each other.



**100% User benefits!**

CAS stands for a sophisticated battery system that you can now rely on for a wide range of standard and special applications. The multiple use of existing batteries provides you with clear cost advantages. CAS also offers maximum reliability and high investment security of a guaranteed future-proof battery system.